

FLOOR PLAN

37,044 SF

1375 Tri-State Parkway, Gurnee, Illinois

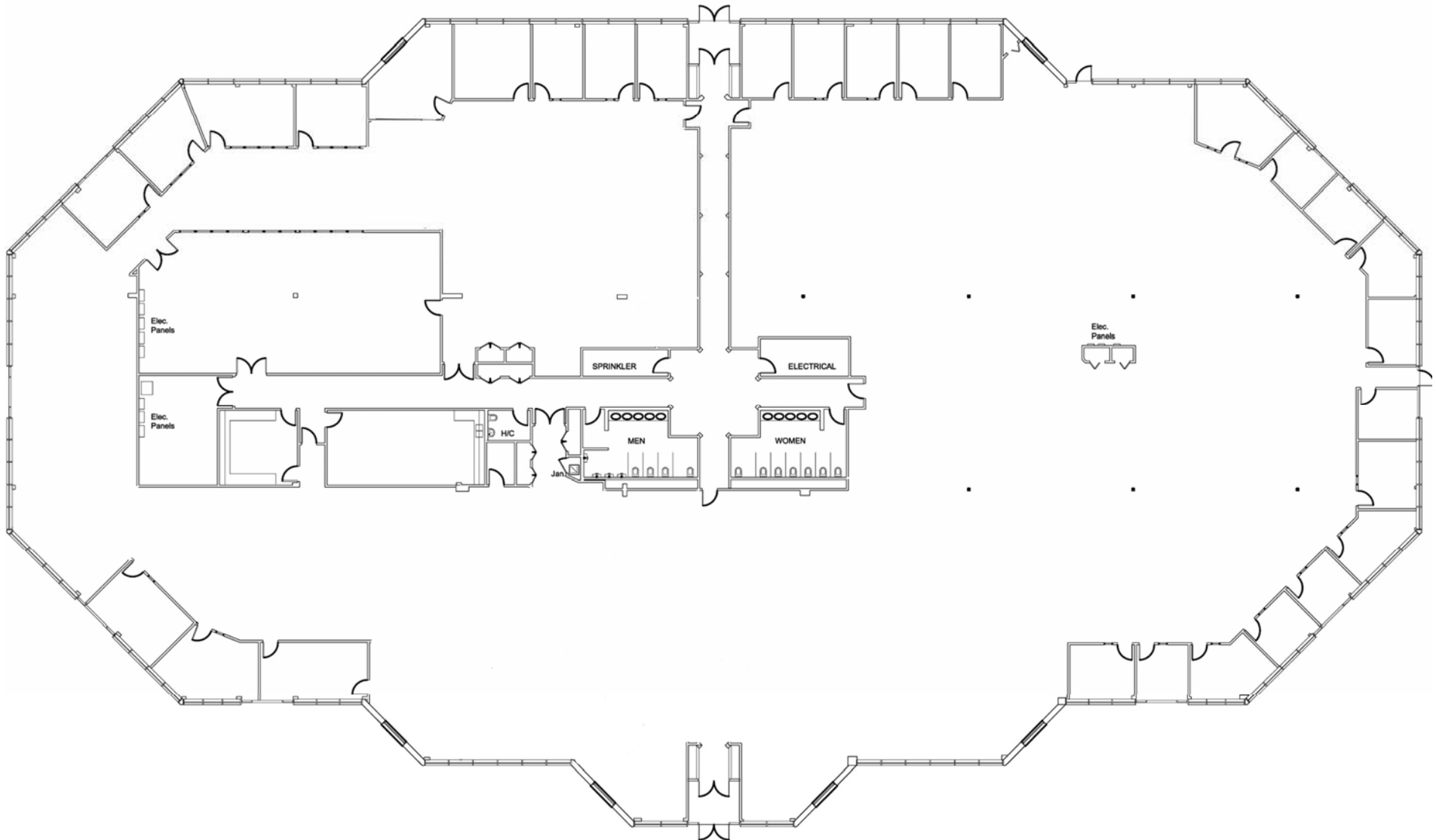

Above information is subject to verification and no liability for errors or omissions is assumed. Prices and availability subject to change and listing may be withdrawn without notice.



Contact: Robert Elbrecht
847.360.1375 x 11
re@tristaterealty.com

Tri-State Realty, Inc.

P.O. Box 502, Gurnee, Illinois 60031
847.360.1375 • Fax 847.360.9667
sales@tristaterealty.com • www.tristaterealty.com

Commercial and Industrial Real Estate • Licensed in Illinois and Wisconsin